



October 11, 2024

The Seattle Department of Neighborhoods
Erin Doherty, Landmarks Preservation Board Coordinator
600 4th Avenue, 4th Floor | PO Box 94649
Seattle, WA 98124-4649

RE: Certificate of Approval
Original Rainier Brewery Tenant Signage

Dear Erin Doherty,

We have a new tenant at the Bottling Plant named RHI, address 5826 Airport Way S. The tenant is located at the north end of the building, with a separate entrance from the rest of the building.

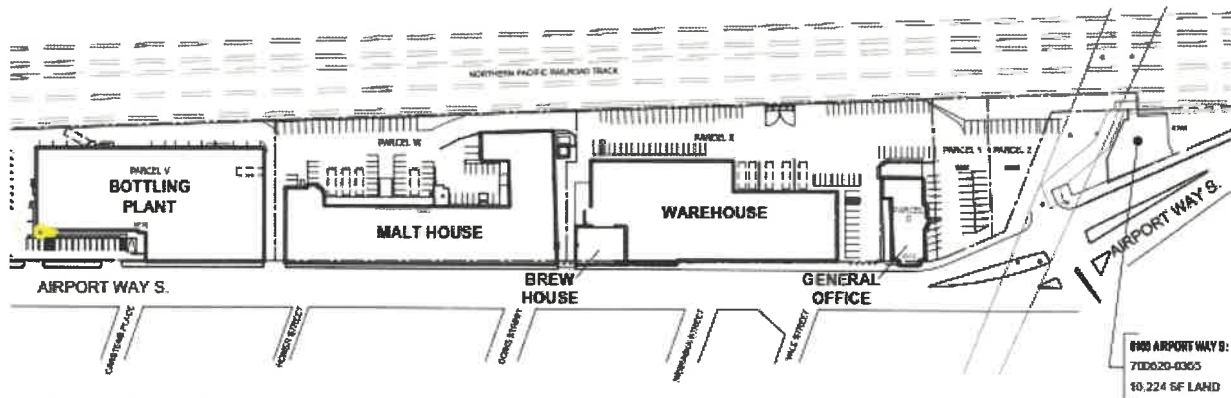

Yellow indicates the location of the signage

Below is a picture of tenant RHI’s individual entrance to the Bottling Plant. RHI plans to mount their signage above the door between the band of bricks and over the door. Current bolts shown in the “before” picture will be removed. The new sign will be mounted on fasteners that are within the mortar joints to avoid damaging any of the historic brick.

SCANLAN KEMPER BARD

5628 Airport Way S, Seattle, WA 98108 425.209.4774 SKBCOS.COM





Here is a larger picture of the Bottling Plant Building. Note that handicapped parking signs are properly on poles, not on the building. The La Tavola sign will be addressed in our next signage approval application addressing the retail spaces in the lower floor of the building.



Here is a picture of the entrance with the RHI sign proposed. The sign itself will be 44" by 24" and the RHI lettering will be about 10" tall.



From the sign company:

I went with a flat sign, brushed silver finish and digital overlay. The sign would be spaced off the building about 1" and mounted on bolts that are anchored into the grout.

Please let us know if this signage plan is approved to go forward or if you need additional information about anything related to this project.

Sincerely,
SKB PMI, LLC
Authorized Agent for Original Rainier Owner, LLC

A handwritten signature in cursive script that reads 'Kelly Zarling'.

Kelly Zarling
Senior Real Estate Manager